

# EASY CLIP

## Special Mechanical Saddle Connections

EASY CLIP



3.2 MECHANICAL SADDLES

Full Special Saddle Range for  
Pipe-Connection Applications  
PVC-U Solvent Welded Clamp  
Saddle Fittings

  
aliaxis

# EASY CLIP

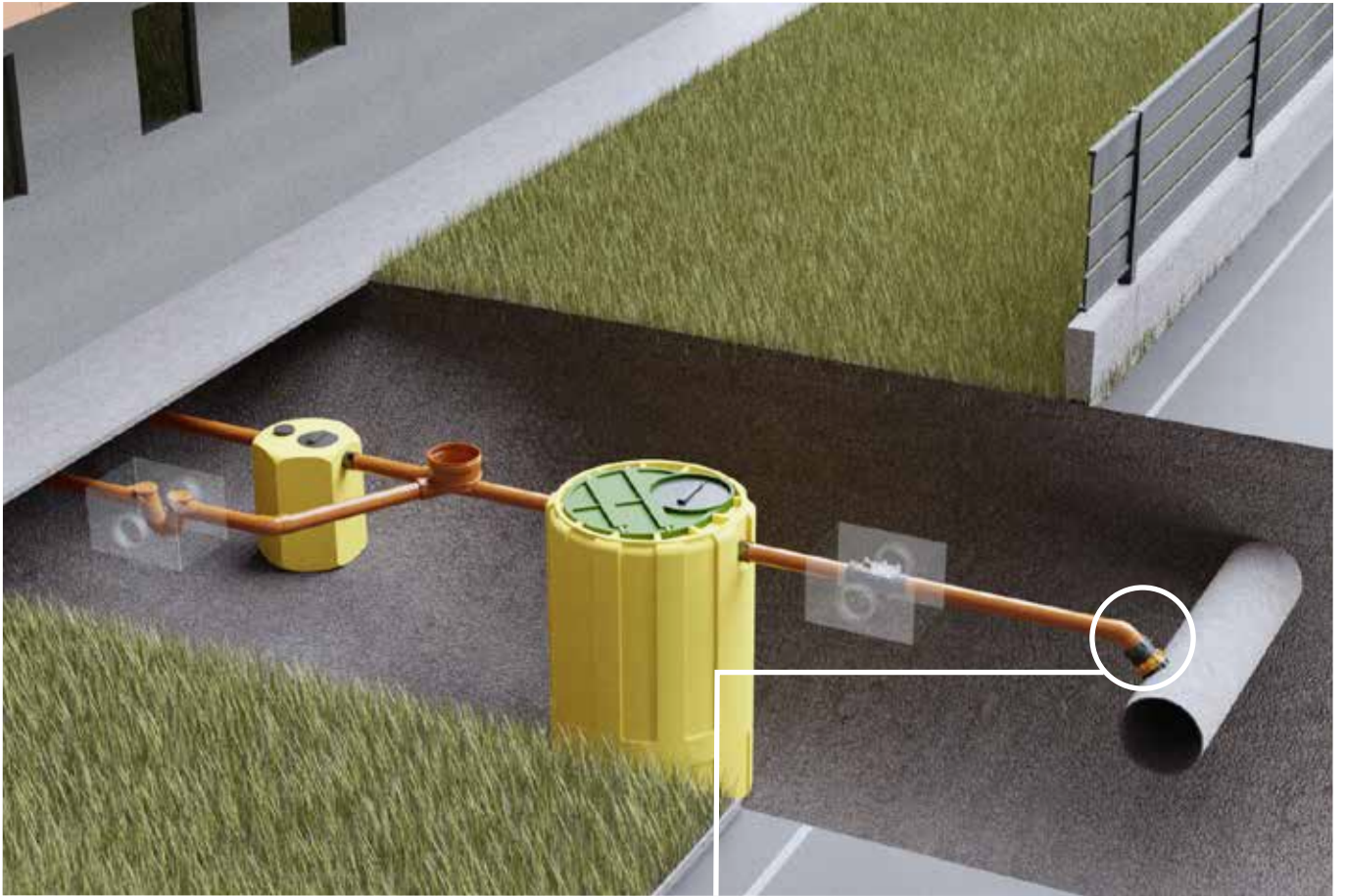

City 	Plus 	Link 	Tech 
 <p><b>Ø160</b></p>	 <p><b>Ø160</b> Spherical joint</p>	 <p><b>Ø160 Ø200</b></p>	 <p><b>Ø160</b></p>
 <p>OD 200÷400</p>	 <p>OD 315÷1000</p>	 <p>OD 315÷1000</p>	 <p>DN 250-300-350</p>
 <p>DN ID 250*</p>	 <p>DN 300÷1200</p>	 <p>DN 300÷1200</p>	 <p>DN 250-300</p>
 <p>DN 200÷250</p>	 <p>DN 300÷1200</p>	 <p>DN 300÷1200</p>	 <p>DN 250-300</p>
<p><b>For pipes with small diameters</b> *≥SN8 complying with EN 13476</p>	<p><b>For all materials, large diameters, absorbs the soil movements</b></p>	<p><b>For all materials, large diameters</b></p>	<p><b>For Concrete and Clay pipes, for hard cleaning</b></p>

## Special Mechanical Connections

Easy Clip special mechanical saddles are products that provide the pipeline connection, without using any type of adhesives or solvent cements. They are particularly suitable for:

### New Installations:

They carry out a lateral connection to the new-set-up drain or sewer system.

### Preexisting Pipelines:

They allow the creation of a new connection to a preexisting drain or sewer system.

Easy Clip range is suitable for both waste and surface water.

The 4 different product models is designed to suit different types of installation.



### City

#### For smaller diameter pipes

Designed for Plastic compact solid wall pipes PVC/PP/PE Ø200-250-315-400. Vitrified Clay pipes Ø200, Ø250. Structured wall (smooth inside) pipes ID 250. Hole saw Ø152 mm. Socket rubber ring Ø160 mm.



### Plus

#### For large diameter pipes

Suitable for any material pipe (plastic compact solid wall, plastic structured wall and smooth inside, concrete). From Ø300 up to Ø1200. Spherical joint (swivel) compensates ground movements. Socket Ø160 rubber ring.



### Link

#### For large diameter pipes

Suitable for any material pipe (compact solid wall, structured wall smooth inside, concrete). From Ø300 up to Ø1200. Either Ø160 or Ø200 socket rubber ring.



### Tech

#### Thick walled concrete & clay pipes

Designed for thick walled concrete and clay pipes Ø250-350. No internal gaps and resistant to "hard cleaning cycles" (e.g. chains, blades, or high pressure water jetting).

# An alternative working method

With traditional collar-type systems, the main difficulty lies in removing the material beneath the existing pipeline. The Easy Clip Connections provide for a completely different and more professional working methodology.

## The main advantages of using a mechanical connection can be summarized in the following points:

- Major reduction of the time required for excavating and backfilling existing pipelines
- Speed of installation
- Installation without the use of sealants
- Ease of installation
- Low overall installation costs
- Guaranteed joint security
- Flexible solutions

Obviously, the pipeline does not have to be "supported", as is the case with traditional collar-type alternatives. The device's mechanical anchoring system simplifies the operation and drastically reduces the installation time.

**Safety:** curing times are not required (as there is no use of cement or adhesives) and the excavation can be immediately backfilled once the intervention has

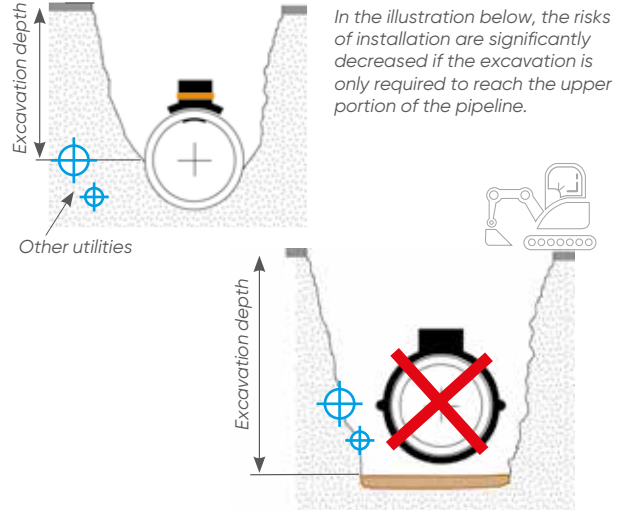
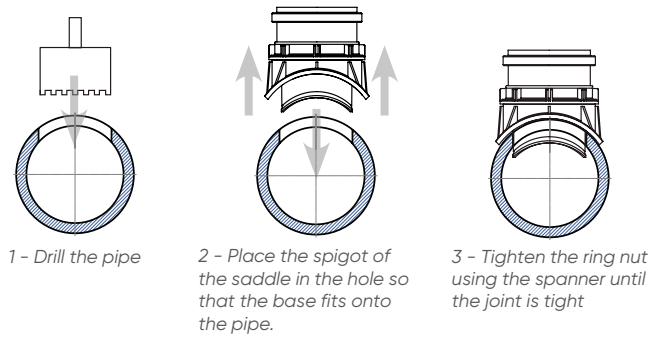

been completed. For this reason, there is no need to leave the excavation open on roads, pathways or residential areas. Therefore there is no need for the work site to be monitored or cordoned off in order to prevent any potential accidents, thus providing significant savings.

### With mechanical saddle

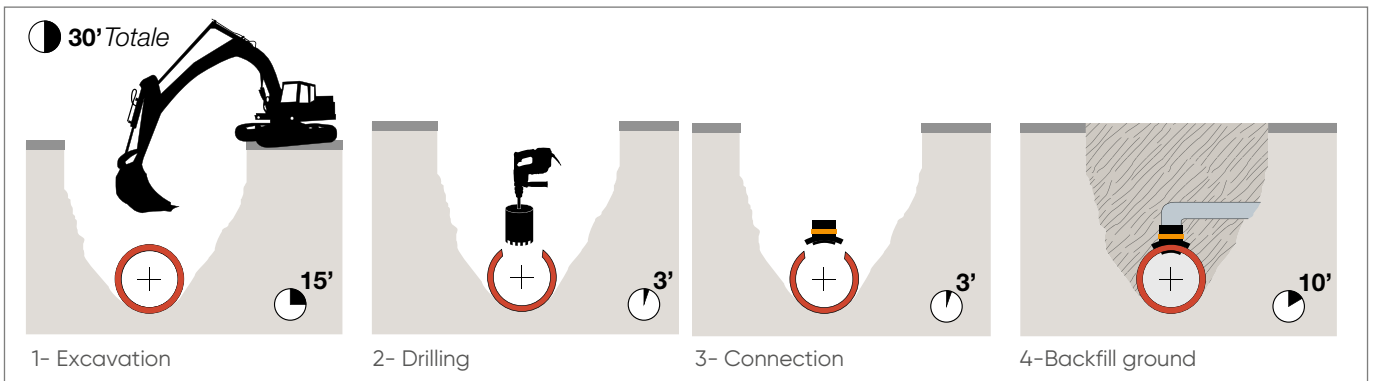

### Without mechanical saddle

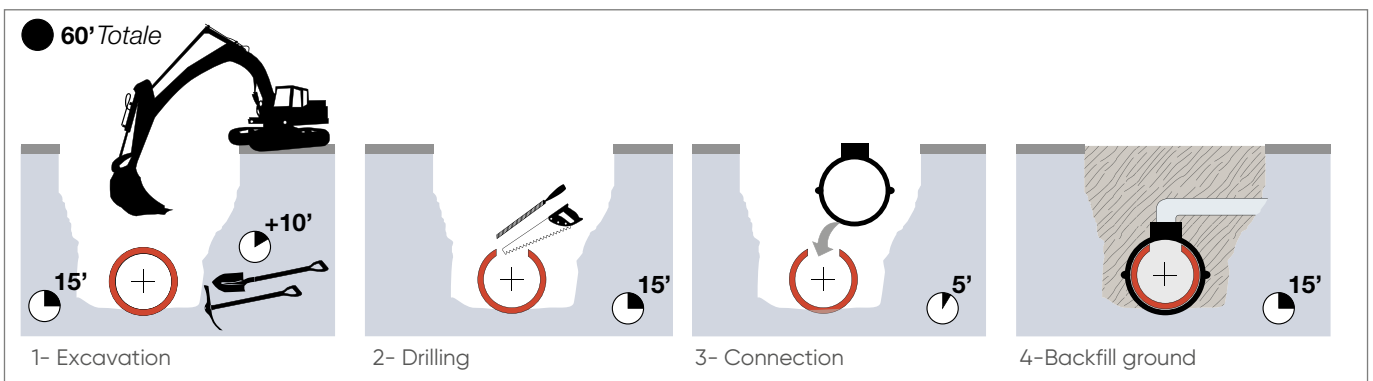



**Installation tips:**

1. Identify the point at which the connection is required and clean away any debris that may be present.
2. Drill the hole perpendicular to the axis of the main pipe

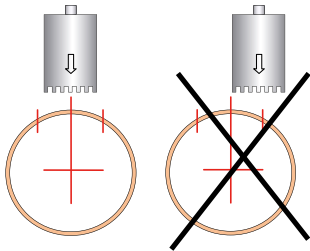

**Note:**

The use of appropriate equipment for centering the pipe will help to prevent errors during this phase. The installation procedure will not be successful if the hole is performed in a decentralized manner. In the case of non-plastic materials (i.e. ceramic or concrete) it is recommended to drill a guide hole (1) initially before completing the hole using a milling tool with a centring drill bit (2). The drilling procedure should always be carried out using water. In the case of plastic materials, it is best to use a milling tool with an incorporated centring drill bit.

If more than one connection needs to be performed on the same tract of pipe, be sure to leave at least 1 meter between each hole.

The installation conditions must always be assessed on a case by case basis: loads, compactness of the terrain, presence of foundations, vehicular traffic, groundwater, etc.

3. Deburr the edges of the hole using a suitable tool, this is especially important for holes made in plastic materials.
4. Lubricate the seal.
5. Insert the Clip and tighten the ring nut.

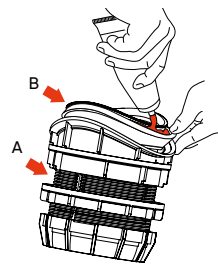

The packaging Easy Clip LINK CITY PLUS include one tube of lubricant gr 150 Art. 6741500

**Installation Easy Clip TECH:**

Easy Clip tech is supplied with one or two adaptors and a spanner. Choose the right adaptor depending on the installation type. For detailed information concerning installation, please see the "installation sheet" contained in the box.

Fix the right adaptor using the supplied screws. Easy Clip Tech is ready to be installed. i.e. on a concrete pipe.



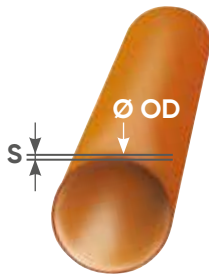

**Compact solid wall wall/multilayer smooth plastic pipes OD**

Installation tube PVC PP PE lisse epaisseur OD

Instalación tubo liso de pared compacta OD

Pipe Ø OD	200	250	315	400
Easy Clip City Ø160	1431158	1432258	1433358	1434458
S (mm)	3÷9	3÷15	3÷15	3÷18



**Installation on PVC/PP/PE compact solid wall pipe OD**

Installation tube PVC/PP/PE epaisseur OD

Instalación tubo PVC/PP/PE de espesor compacto OD

DN (mm)	Ø (mm)	S Max Pipe	L1 (mm)	L2 (mm)	Reference	**		Hole saw
200	160	9 mm	255	195	1431158	1	80	AD1513P

\*\* Every clip is individually packed in a plastic wrapper, along with a tube of lubricant and assembly instructions. (lubricant included Art.6741500 gr. 150)

**1 spanner included in each box of 6 pcs.**

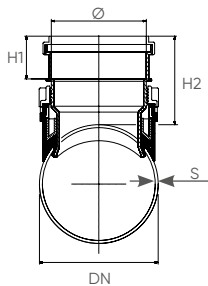

**Installation on PVC/PP/PE compact solid wall pipe OD**

Installation tube PVC/PP/PE epaisseur OD

Instalación tubo PVC/PP/PE de espesor compacto OD

DN (mm)	Ø (mm)	S Max Pipe	L1 (mm)	L2 (mm)	Reference	**		Hole saw
250	160	15 mm	285	290	1432258	1	48	AD1513P
315	160	15 mm	315	290	1433358	6	48	AD1513P
400	160	18 mm	360	290	1434458	1	48	AD1513P

\*\* Every clip is individually packed in a plastic wrapper, along with a tube of lubricant and assembly instructions. (lubricant included Art.6741500 gr. 150)

**1 spanner included in each box of 6 pcs.**

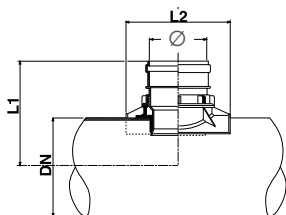

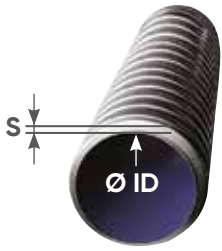

**Twin/structured wall plastic pipe ID**  
**Installation tube annelé ID**  
**Instalación tubo corrugado ID**

<b>Pipe Ø ID</b>	<b>Ø ID 250</b>
Easy Clip City Ø160	1432658
S (mm)	20÷30



**Installation on corrugated pipe ≥SN8 (EN13476)**  
**Installation tube annelé ≥SN8 (EN13476)**  
**Instalación tubo corrugado ≥SN8 (EN13476)**

DN ID	Ø	S Max Pipe	L1	L2	L3	Ref.	Box **	Pallet	Hole saw
250	160	20÷35	182	290	236	1432658	1	48	AD1513P

\*\* Every clip is individually packed in a plastic wrapper, along with a tube of lubricant and assembly instructions.  
 (lubricant included Art.6741500 gr. 150)  
**1 spanner included in each box of 6 pcs.**

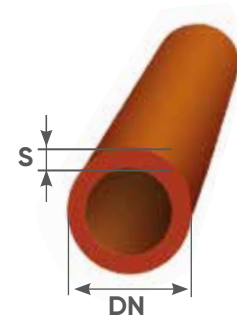
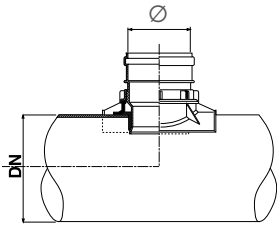

**Clay pipe (nominal diameter)**  
**Installation tube grès (diamètre nominal)**  
**Instalación tubo gres (diámetro nominal)**

<b>Pipe DN</b>	<b>DN 200</b>	<b>DN 250</b>
Easy Clip City Ø160	1431658	1432658
Thickness Class According to EN 295-1	Class 160 / 240	Class 160 / 240
S (mm)	15÷28	20÷37

**Installation on clay pipe (UNI EN 295-1)**  
**Installation tube grès (UNI EN 295-1)**  
**Instalación tubo gres (UNI EN 295-1)**

	DN ID	OD	Class	Ø KN/M <sup>2</sup>	H (mm)	L1 (mm)	L2 (mm)	L3 (mm)	Ref.	Box **	Pallet	Hole saw
Pipe standard	200	242	160	160	158	194	290	219	1431658	1	48	AC1KSDZ
Pipe standard	200	254	240	160	152							
Pipe standard	250	299	160	160	161	182	290	236	1432658	1	48	AC1KSDZ
Pipe extra	250	318	240	160	151							

\*\* Every clip is individually packed in a plastic wrapper, along with a tube of lubricant and assembly instructions.  
 (lubricant included Art.6741500 gr. 150)  
**1 spanner included in each box of 6 pcs.**

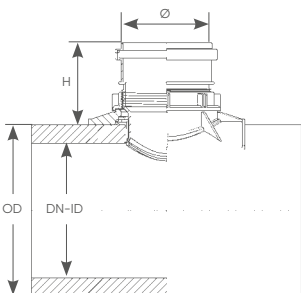
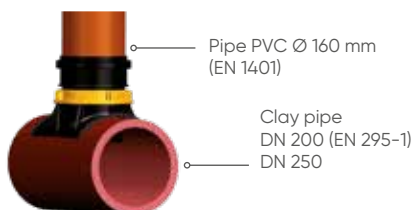

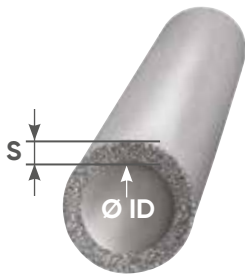

ID = Internal Diameter OD = Outside Diameter S = Wall thickness DN = Nominal Diameter

# Plus



## Reinforced concrete pipe ID Installation tube en béton ID Instalación tubo hormigón ID

Pipe Ø ID		300	400	500	600	700÷1200
Easy Clip Plus Ø160 with swivel	 	1C16058	1E16058	1H16058	1H16058	1K16058
S (mm)		30÷80	30÷80	40÷100	40÷100	40÷100

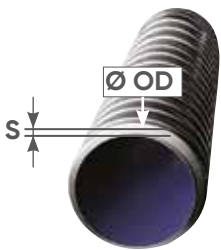

## Twin/structured wall plastic pipe OD Installation tube annelé epaisseur OD Instalación tubo corrugado de espesor OD

Pipe Ø OD		315	400	500	630	800÷1000
Easy Clip Plus Ø160 with swivel		1A16058	1D16058	1G16058	1K16058	1K16058
S (mm)		5÷30	6÷35	9÷50	9÷50	20÷100
Easy Clip Plus shorter version Ø160 with swivel		1Y16058	1X16058	<b>Shorter version</b>		
S (mm)		5÷30	6÷35			

Pipe conform to EN13476 ≥ SN8

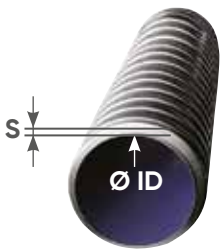

## Twin/structured wall plastic pipe ID Installation tube annelé ID Instalación tubo corrugado ID

Tubo / Pipe Ø ID		300	400	500	600	700÷1200
Easy Clip Plus Ø160 with swivel		1A16058	1E16058	1G16058	1H16058	1K16058
S (mm)		5÷30	30-80	20-65	40÷100	40÷100
Easy Clip Plus Ø160 Shorter version with swivel		1Y16058	1Z16058	<b>Shorter version</b>		
S (mm)		5÷30	30÷55			

Pipe conform to EN13476 ≥ SN8

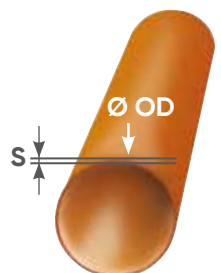

## GRP compact solid wall/multilayer smooth plastic pipe OD Installation tube PVC PP PE PRV lisse epaisseur OD Instalación tubo liso de pared compacta OD

Tubo / Pipe Ø OD		315	400	500÷630	710÷1000
Easy Clip Plus Ø160 with swivel	 	1A16058	1D16058	1G16058	1J16058
S (mm)		5÷30	6÷35	9÷50	10÷60
Easy Clip Plus Ø160 Shorter version with swivel	 	1Y16058	1Z16058	<b>Shorter version</b>	
S (mm)		5÷30	30÷55		





**Installation on structured, compact solid wall, clay, concrete and GRP pipe**

**Installation tube en béton, annelé, lisse**

**Instalación tubo de hormigón, corrugado, liso de pared compacta**



Easy Clip Plus Ø 160 mm

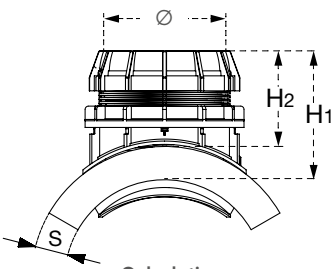

Calculation:  
 $H2 = H1 - S (\pm 0,5 \text{ cm})$   
 S= wall thickness

Ø (mm)	H1 (mm)	Reference	Certif.	Box**	Pallet	Hole saw
160	255	1A16058	QB MPA	1	38	AD2013P (for plastic)
160	255	1C16058	QB MPA	1	38	AC2CSDZ (for non plastic)
160	255	1D16058	QB MPA	1	38	AD2013P
160	255	1E16058	QB MPA	1	38	AC2CSDZ
160	255	1G16058	QB MPA	1	38	AD2013P
160	255	1H16058	QB MPA	1	38	AD2013P / AC2CSDZ
160	255	1J16058	QB MPA	1	38	AD2013P
160	255	1K16058	QB MPA	1	38	AD2013P / AC2CSDZ
160	205	1X16058*	QB	1	38	AD2013P
160	205	1Y16058	QB MPA	1	38	AD2013P
160	205	1Z16058*	QB	1	38	AD2013P

\*upon request

\*\*Every clip is individually packed in a cardboard box, along with a specific spanner, a tube of lubricant and assembly instructions. (lubricant included Art.6741500 gr.150)



AFNOR-CSTB: ANF EN 1401

MPA: DIN EN 13598-1



Swivel joint



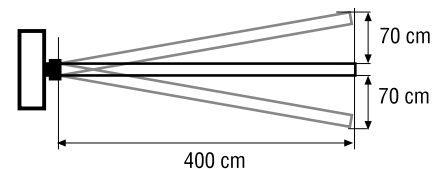
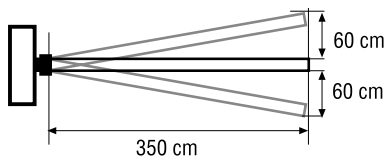
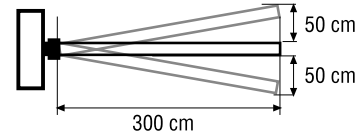
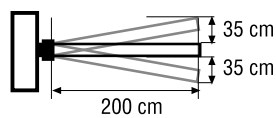

European Patent EP1548349

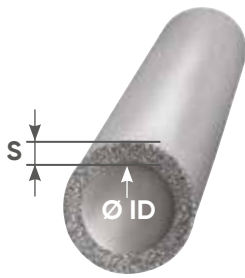

# Link



## Reinforced concrete and clay pipe ID Installation tube en béton et gres ID Instalación tubo de hormigón o gres ID

Pipe Ø ID		300	400	500	600	700÷1200
Easy Clip Link Ø160	 	1C16L58	1E16L58	1H16L58	1H16L58	1K16L58
S (mm)		30÷80	30÷80	40÷120	40÷120	40÷120
Easy Clip Link Ø200	 	1C20058	1E20058	1H20058	1H20058	1K20058
S (mm)		30÷80	30÷80	40÷100	40÷100	40÷100

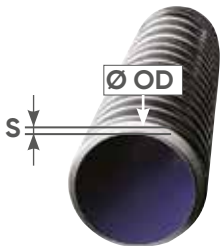

Pipe congorm to  
EN13476 ≥ SN8

## Twin/structured wall plastic pipe OD Installation tube annelé epaisseur OD Instalación tubo corrugado de espesor OD

Pipe Ø OD		315	400	500÷630	800÷1000
Easy Clip Link Ø160		1A16L58	1D16L58	1G16L58	1K16L58
S (mm)		5÷30	6÷35	9÷50	20÷100
Easy Clip Link Ø200		1A20058	1D20058	1G20058	1K20058
S (mm)		5÷30	6÷35	9÷50	20÷100
Easy Clip Link Ø160		1Y16L58	1X16L58	<b>Shorter version</b>	
S (mm)		5÷30	6÷35		
Easy Clip Link Ø200		1Y20058	1X20058	<b>Shorter version</b>	
S (mm)		5÷30	6÷35		

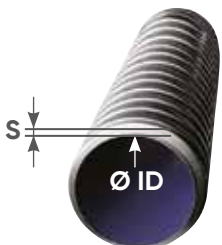



Pipe congorm to  
EN13476 ≥ SN8

## Twin/structured wall plastic pipe ID Installation tube annelé ID Instalación tubo corrugado ID

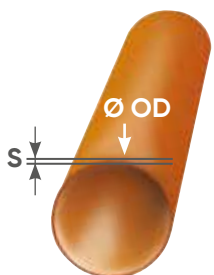
Pipe Ø ID		300	400	500	600	700÷1200
Easy Clip Link Ø160		1A16L58	1E16L58	1G16L58	1H16L58	1K16L58
S (mm)		15÷30	30÷80	20÷80	40÷120	40÷120
Easy Clip Link Ø200		1A20058	1E20058	1G20058	1H20058	1K20058
S (mm)		15÷30	30÷80	20÷65	40÷100	40÷100
Easy Clip Link Ø160		1Y16L58	1Z16L58	<b>Shorter version</b>		
S (mm)		15÷30	30÷70			
Easy Clip Link Ø200		1Y20058	1Z20058	<b>Shorter version</b>		
S (mm)		15÷30	30÷55			



## Compact solid wall/multilayer smooth plastic pipe OD Installation tube PVC PP PE lisse epaisseur OD Instalación tubo liso de pared compacta OD

Pipe Ø OD		315	400	500÷630	710÷1000
Easy Clip Link Ø160	 	1A16L58	1D16L58	1G16L58	1J16L58
S (mm)		5÷30	6÷35	9÷50	10÷80
Easy Clip Link Ø200	 	1A20058	1D20058	1G20058	1J20058
S (mm)		5÷30	6÷35	9÷50	10÷60
Easy Clip Link Ø160	 	1Y16L58	<b>Shorter version</b>		
S (mm)		5÷30			
Easy Clip Link Ø200	 	1Y20058	<b>Shorter version</b>		
S (mm)		5÷30			



**Link 160**

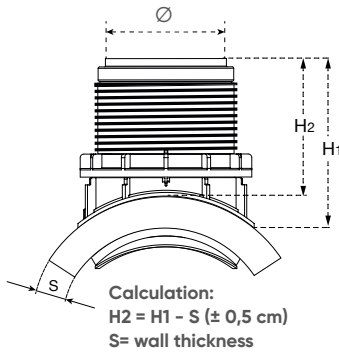

**Link 200**

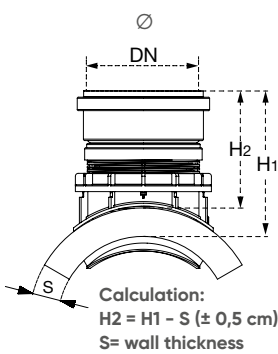

**Installation on structured, compact solid wall, clay, concrete and GRP pipe**

**Installation tube en béton, annelé, lisse**

**Instalación tubo de hormigón, corrugado, liso de pared compacta**

Ø (mm)	H1 (mm)	Reference	Cert.	Box**	Spanner	Hole saw
160	255	1A16L58	QB MPA	1	38	AD2013P (for plastic)
160	255	1C16L58	QB MPA	1	38	AC2CSDZ (for non plastic)
160	255	1D16L58	QB MPA	1	38	AD2013P
160	255	1E16L58	QB MPA	1	38	AC2CSDZ
160	255	1G16L58	QB MPA	1	38	AD2013P
160	255	1H16L58	QB MPA	1	38	AD2013P / AC2CSDZ
160	255	1J16O58	QB MPA	1	38	AD2013P
160	255	1K16L58	QB MPA	1	38	AD2013P / AC2CSDZ
160	205	1X16L58	QB	1	38	AD2013P
160	205	1Y16L58	QB MPA	1	38	AD2013P
160	205	1Z16L58	QB	1	38	AD2013P
200	315	1A20O58	QB MPA	1	38	AD2013P (for plastic)
200	315	1C20O58	QB MPA	1	38	AC2CSDZ (for non plastic)
200	315	1D20O58	QB MPA	1	38	AD2013P
200	315	1E20O58	QB MPA	1	38	AC2CSDZ
200	315	1G20O58	QB MPA	1	38	AD2013P
200	315	1H20O58	QB MPA	1	38	AD2013P / AC2CSDZ
200	315	1J20O58	QB MPA	1	38	AD2013P
200	315	1K20O58	QB MPA	1	38	AD2013P / AC2CSDZ
200	265	1X20O58*	QB	1	38	AD2013P
200	265	1Y20O58	QB MPA	1	38	AD2013P
200	265	1Z20O58	QB	1	38	AD2013P

\*upon request

\*\*Every clip is individually packed in a cardboard box, along with a specific spanner, a tube of lubricant and assembly instructions. (lubricant included Art.6741500 gr. 150)



AFNOR-CSTB: ANFN EN 1401

MPA: DIN EN 13598-1

3.2 MECHANICAL SADDLES

**Tech** 

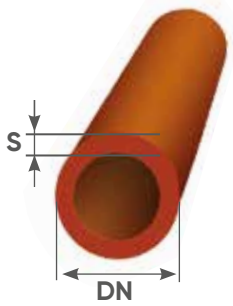

**Clay pipe (nominal diameter)**

Installation tube grès (diamètre nominal)

Instalación tubo gres (diámetro nominal)

Pipe DN	250	300	350
Clay*	1T21658	1T11658	1T11658
S (mm)	Min. 23	Min. 23	Min. 23

\* Dimensions according to the EN295-1

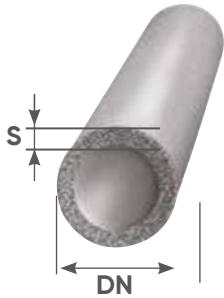

**Reinforced concrete pipe (nominal diameter)**

Installation tube en béton (diamètre nominal)



Instalación tubo hormigón (diámetro nominal)

Pipe DN	250	300
Concrete	1T11658	1T11658
S (mm)	Min. 23	Min. 23

**Installation on Concrete and clay pipe**

Installation tube en béton ou grès

Instalación tubo de hormigón o gres



Ø (mm)	H (mm)	Reference			Note
160	260	1T11658*	1	24	
160	260	1T21658*	1	24	

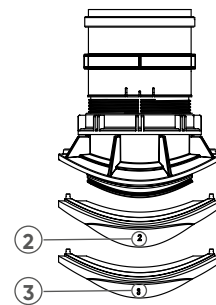
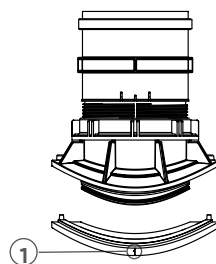
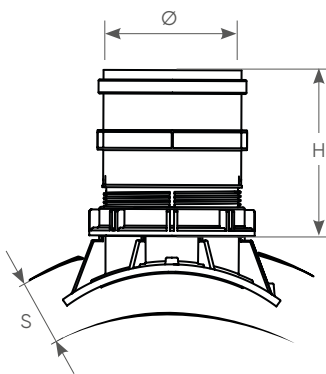

H = Ledge Easy Clip installed on tube  
\*upon request

Every clip is individually packed in a cardboard box, along with a specific spanner and assembly instructions.

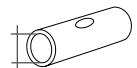
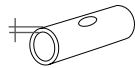

**Adaptors**

Cod. 1T11658			
			
Clay Grés	DN 300	N - Class 160*	①
	DN 350	H - Class 240*	NO
Concrete Beton	DN 250	N - Class 160*	①
	DN 300	H - Class 240*	NO

Cod. 1T21658			
			
Clay Grés	DN 250	N - Class 160*	②
	DN 250	H - Class 240*	③

**Note:**

Designed for concrete and clay pipes DN 250, 300, 350. With high thicknesses. Without internal gaps. Resistant to the sewage "hard cleaning cycles" (e.g. chains, blades, or hi pressur waterjet).

ID = Internal Diameter OD = Outside Diameter S = Wall thickness DN = Nominal Diameter





**Compact inverter reducer**  
**Tampon de reducción avec joint**  
**Reducción concéntrica**

DN (mm)	DN1 (mm)	DN2 (mm)	H (mm)	H1 (mm)	S (mm)	Reference Black			Note
110	160	166	69.5	57	4	0686348	16	384	

Material: PVC-U  
 Gasket: locked preformed EN681  
 Dimensions complying EN1401/EN1329

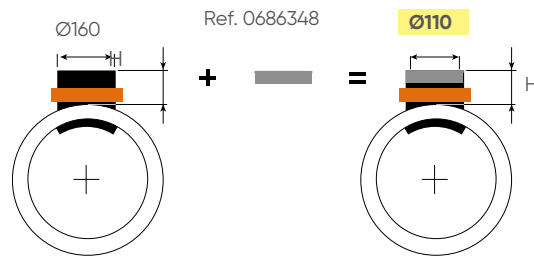
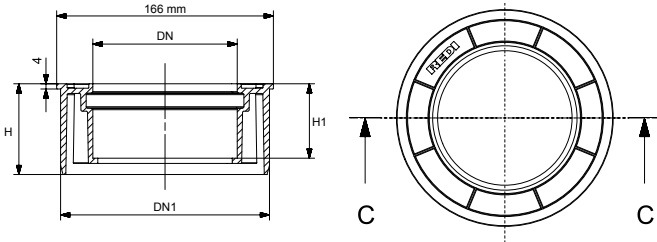

**Recommended for installation on Easy Clip City, Link and Tech**

**Reference**  
 143ID58  
 1432658  
 1431658



**City**

**Reference**  
 1A16L58  
 1C16L58  
 1D16L58  
 1E16L58  
 1G16L58  
 1H16L58  
 1J16L58  
 1K16L58  
 1X16L58  
 1Y16L58  
 1Z16L58



**Link<sub>160</sub>**

**Reference**  
 1T11658  
 1T21658



**Tech**



**Not for installation on Easy Clip Plus**  
**Plus**

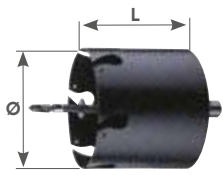

DUSS made in Germany

### Hole saw for plastic pipes

Scie cloches pour tubes plastiques PP PE PVC

Corona de corte para tubo de material PLÁSTICO

Ø (mm)	L (mm)	Mandren	Pilot bit	Long endurance	Reference			Note
200	163	13mm	✓	✓	AD2013P	1	52	Pipes from Ø250
152(6")	163	13mm	✓	✓	AD1513P	1	-	Pipes from Ø200

Suitable for drilling materials:  
PVC / PP / PE / GRP (sand free)

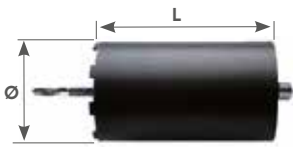

DUSS made in Germany

### Hole saw for NON plastic pipes

Scie cloches pour tubes béton ou grès

Corona de corte para tubo de material NO PLÁSTICO

Ø (mm)	L (mm)	Mandren	Pilot bit	Long endurance	Reference			Note
202	300	SDS max	✓	✓	AC2CSDZ	1	8	Pipes from Ø250
152(6")	300	SDS max	✓	✓	AC1KSDZ*	1	-	

Suitable for drilling materials:  
Reinforced concrete / Reinforced corrugated steel / Fiber glass filled with sand / Clay

\*upon request

## Spare parts - Pièces de rechang - Repuestos

### Spanner for CITY and TECH

Clé de serrage pour CITY ou TECH

Llave para CITY o TECH



DN (mm)	Reference			Note
160	0996606	1	720	Open

### Spanner for PLUS and LINK 160

Clé de serrage pour PLUS ou LINK 160

Llave para PLUS o LINK 160



closed

DN (mm)	Reference			Note
160	0995508	1	400	Closed

### Spanner for LINK 200

Clé de serrage pour LINK 200

Llave para LINK 200



open

DN (mm)	Reference			Note
200	0996008	1	400	Open



### Saddle SCJ 45°

Clip à coller 45° - Injerto 45° con junta labiada

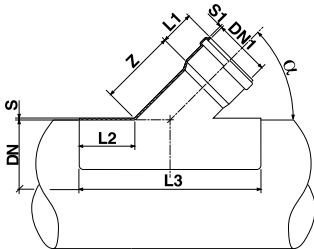

DN (mm)	DN1 (mm)	$\alpha$	S (mm)	S1 (mm)	Z (mm)	L1 (mm)	L2 (mm)	L3 (mm)	Reference RAL 7037 Grey	Reference RAL 8023 Red		
160	125	45°	3.2	3.0	128	62	65	300	0438042	0438091	15	120
200	125	45°	4.1	3.0	128	62	85	340	0438242	0438291	10	80
200	160	45°	4.1	3.6	165	73	85	390	0438442	0438491	10	60
250	125	45°	5.5	3.0	128	62	92	350	0438642	0438691	10	70
250	160	45°	5.5	3.6	165	73	92	400	0438842	0438891	6	48
315	125	45°	5.5	3.0	128	62	92	350	-	1439091	5	40
315	160	45°	6.9	3.6	165	73	110	432	0439442	0439491	5	30
315	200	45°	6	4.4	236	95	86	513	1433242*	-	-	-
400	125	45°	5.5	3.0	128	62	92	350	-	1439191	5	40
400	160	45°	5.5	3.6	165	73	92	400	-	1439591	3	24
500	125	45°	5.5	3.0	128	62	92	350	1439242*	1439291	-	-
500	160	45°	5.5	3.6	165	73	92	400	-	1439691	3	24

\*upon request

Fixed Ring Lip Ring



### Saddle SCJ 90°

Clip à coller 90° - Injerto 90° con junta labiada

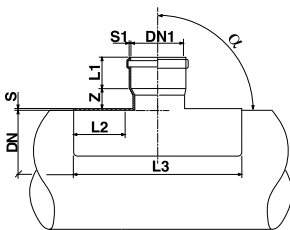

DN (mm)	DN1 (mm)	$\alpha$	S (mm)	S1 (mm)	Z (mm)	L1 (mm)	L2 (mm)	L3 (mm)	Reference RAL 7037 Grey	Reference RAL 8023 Red		
200	160	90°	4.4	3.6	34	58.5	77	322	-	0434351	10	80
250	160	90°	4.4	3.6	34	58.5	77	322	-	1424251	8	64
315	160	90°	-	-	-	-	-	-	-	142525E	8	64
400	160	90°	-	-	-	-	-	-	-	142625E	7	56

Fixed Ring Lip Ring

# Guide to choose the right mechanical saddle

## Installation on compact or multilayer smooth plastic pipes OD

### Installation tube PVC PP PE lisse epaisseur OD - Instalación tubo liso de pared compacta OD

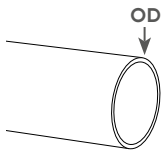

Pipe Ø 200	Pipe Ø 250	Pipe Ø 300	Pipe Ø 315	Pipe Ø 400	Pipe Ø 500	Pipe Ø 600	Pipe Ø 630	Pipe Ø 700	Pipe Ø 710	Pipe Ø 800	Pipe Ø 1000	Pipe Ø 1200	Diam. inlet Easy Clip
1431158 City	1432258 City		1433358 City	1434458 City									Ø 160
			1A16058 Plus	1D16058 Plus	1G16058 Plus					1J16058 Plus			Ø 160
			1Y16058 Plus	1X16058 Plus									Ø 160 Shorter
			1A16L58 Link	1D16L58 Link	1G16L58 Link					1J16L58 Link			Ø 160
			1A20058 Link	1D20058 Link	1G20058 Link					1J20058 Link			Ø 200
			1Y16L58 Link	1X16L58 Link									Ø 160 Shorter
			1Y20058 Link	1X20058 Link									Ø 200 Shorter

## Twin/structured wall plastic pipe OD

### Installation tube annelé epaisseur OD - Instalación tubo corrugado de espesor OD

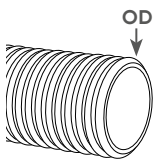

Pipe Ø 200	Pipe Ø 250	Pipe Ø 300	Pipe Ø 315	Pipe Ø 400	Pipe Ø 500	Pipe Ø 600	Pipe Ø 630	Pipe Ø 700	Pipe Ø 710	Pipe Ø 800	Pipe Ø 1000	Pipe Ø 1200	Diam. inlet Easy Clip
			1A16058 Plus	1D16058 Plus	1G16058 Plus		1K16058 Plus			1K16058 Plus			Ø 160
			1A16L58 Link	1D16L58 Link	1G16L58 Link					1K16L58 Link			Ø 160
			1A20058 Link	1D20058 Link	1G20058 Link					1K20058 Link			Ø 200
			1Y16L58 Link	1X16L58 Link									Ø 160 Shorter
			1Y20058 Link	1X20058 Link									Ø 200 Shorter

## Reinforced concrete and clay pipe DN

### Installation tube en béton et grès DN - Instalación tubo de hormigón o grès DN

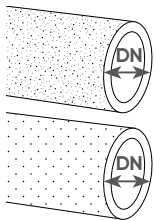

Pipe Ø 200	Pipe Ø 250	Pipe Ø 300	Pipe Ø 315	Pipe Ø 400	Pipe Ø 500	Pipe Ø 600	Pipe Ø 630	Pipe Ø 700	Pipe Ø 710	Pipe Ø 800	Pipe Ø 1000	Pipe Ø 1200	Diam. inlet Easy Clip
1431658 City	1432658 City												Ø 160
	1T21658 Tech	1T11658 Tech											Ø 160
	1T11658 Tech												Ø 160

## Reinforced concrete and clay pipe ID

### Installation tube en béton et grès ID - Instalación tubo de hormigón o grès ID

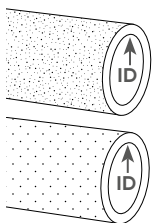

Pipe Ø 200	Pipe Ø 250	Pipe Ø 300	Pipe Ø 315	Pipe Ø 400	Pipe Ø 500	Pipe Ø 600	Pipe Ø 630	Pipe Ø 700	Pipe Ø 710	Pipe Ø 800	Pipe Ø 1000	Pipe Ø 1200	Diam. inlet Easy Clip
		1C16058 Plus		1E16058 Plus	1H16058 Plus					1K16058 Plus			Ø 160
		1C16L58 Link		1E16L58 Link	1H16L58 Link					1K16L58 Plus			Ø 160
		1C20058 Link		1E20058 Link	1H20058 Link					1K20058 Link			Ø 200

## Twin/structured wall plastic pipe ID

### Installation tube annelé ID - Instalación tubo corrugado ID

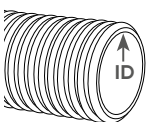

Pipe Ø 200	Pipe Ø 250	Pipe Ø 300	Pipe Ø 315	Pipe Ø 400	Pipe Ø 500	Pipe Ø 600	Pipe Ø 630	Pipe Ø 700	Pipe Ø 710	Pipe Ø 800	Pipe Ø 1000	Pipe Ø 1200	Diam. Innesto Easy Clip
	1432658 City												Ø 160
		1A16058 Plus		1E16058 Plus	1G16058 Plus	1H16058 Plus				1K16058 Plus			Ø 160
		1A16L58 Link		1E16L58 Link	1G16L58 Link	1H16L58 Link				1K16L58 Link			Ø 160
		1A20058 Link		1E20058 Link	1G20058 Link	1H20058 Link				1K20058 Link			Ø 200
		1Y16L58 Link		1Z16L58 Link									Ø 160 Shorter
		1Y20058 Link		1Z20058 Link									Ø 200 Shorter



on-line Easy Clip CONFIGURATOR <https://configuratore.redi.it/>