

OKAB - Profile backing ring PP

Profiled backing ring PP with cast iron core for stub flange according to ANSI B16.5 class 150.

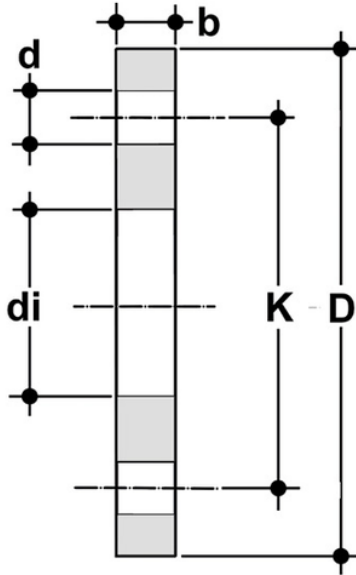

| Codice | d _i | DN | **PMA | b | D | d | K | M | ***n | Nm | g |
|---------|----------------|-----|-------|----|-----|----|-----|-----|------|-----|-------|
| OKAB200 | *63 | 50 | 16 | 18 | 164 | 19 | 121 | M16 | 4 | 30 | 0,72 |
| OKAB300 | *90 | 80 | 16 | 19 | 196 | 19 | 153 | M16 | 4 | 40 | 0,94 |
| OKAB400 | *110 | 100 | 16 | 25 | 237 | 19 | 191 | M16 | 8 | 40 | 1,84 |
| OKAB600 | *160 | 150 | 16 | 30 | 297 | 22 | 242 | M20 | 8 | 60 | 2,8 |
| OKAB800 | *225 | 200 | 16 | 34 | 354 | 22 | 299 | M20 | 8 | 80 | 4,6 |
| OKAB810 | *250 | 250 | 16 | 38 | 425 | 26 | 362 | M20 | 12 | 90 | 6,56 |
| OKAB812 | *315 | 300 | 16 | 51 | 497 | 26 | 432 | M20 | 12 | 100 | 11,28 |