

ODB-SW

Steel core backing ring, PP/FRP coated, according to EN/ISO/DIN for stubs QRV and QPV. Drilling: PN 10/16 up to DN 150; PN 10 from DN 200.

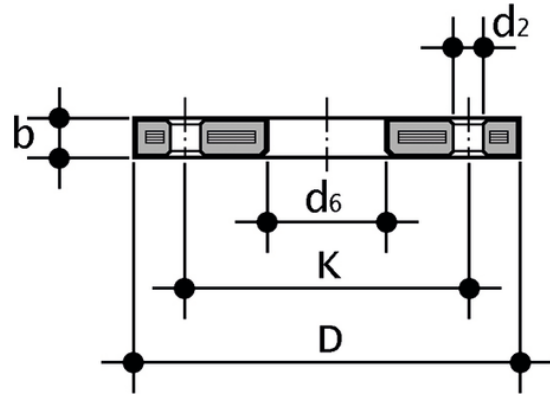

FOR QRC

Reference	d	DN	PMA (bar)	b	D	d ₂	d ₆	k	M	(Nm)	n	g
SWOBD225DN200	225	200	16	27	340	22	247	295	M20	75	8	5060

FOR QRV AND QPV

Reference	d	DN	PMA (bar)	b	D	d ₂	d ₆	k	M	(Nm)	n	g
SWOBD140DN125	140	125	16	24	252	18	166	210	M16	60	8	2965
SWOBD225DN200	225	200	16	27	340	22	248	295	M20	75	8	5060
SWOBD280DN250	280	250	16	30	395	22	309	350	M20	95	12	7112
SWOBD315DN300	315	300	16	34	445	22	349	400	M20	100	12	9468