

ODBC - Flange ISO-DIN series

Steel core blind flange, PP/FRP according to EN/ISO/DIN. Drilling: PN 10/16.

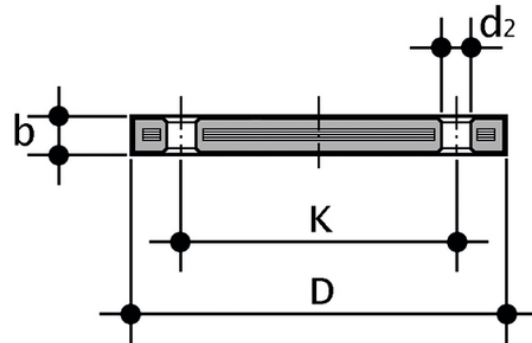

Reference	d	DN	PMA (bar)	b	d ₂	D	k	M	n	*Nm	g
ODBC020	20	15	10	16	14	95	65	M12	4	15	290
ODBC025	25	20	10	12	18	105	75	M12	4	15	380
ODBC032	32	25	10	18	14	115	85	M12	4	15	600
ODBC040	40	32	10	17	18	140	100	M16	4	25	830
ODBC050	50	40	10	18	18	150	110	M16	4	35	1105
ODBC063	63	50	10	18	18	165	125	M16	4	35	1308
ODBC075	75	65	10	18	18	185	145	M16	4	40	1580
ODBC090	90	80	10	20	18	200	160	M16	8	40	2244
ODBC110	110	100	10	20	18	220	180	M16	8	45	2829
ODBC125	125	100	10	20	18	220	180	M16	8	45	2873
ODBC140	*140	125	10	24	18	250	210	M16	8	50	3920
ODBC160	160	150	10	22	22	285	240	M20	8	60	7181
ODBC180	180	150	10	24	22	285	240	M20	8	60	7130
ODBC200	200	200	10	24	22	340	295	M20	8	70	10580
ODBC225	225	200	10	24	22	340	295	M20	8	70	10664
ODBC250	250	250	10	30	22	395	350	M20	12	100	14040
ODBC280	280	250	10	30	22	395	350	M20	12	100	14040
ODBC315	315	300	10	34	22	445	400	M20	12	110	26480
ODBC355	*350	350	10	39	22	505	460	M20	16	160	39000
ODBC400	*400	400	10	46	25	574	515	M24	16	170	50400