

ODB - Flange ISO-DIN series

Steel core backing ring, PP/FRP coated, according to EN/ISO/DIN for stub QRNM. Drilling: PN 10/16.

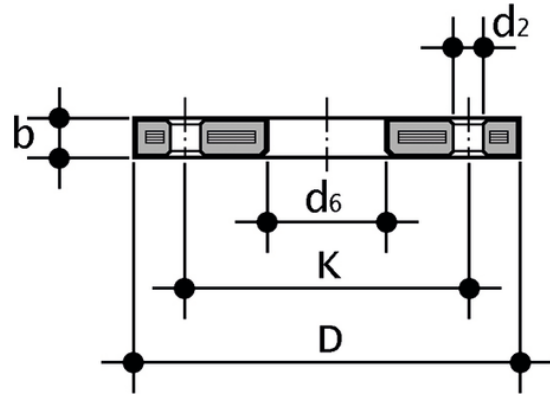

Reference	d	DN	*PMA (bar)	b	d ₂	d ₆	D	K	M	n	**Nm	g
ODB020	20	15	16	12	14	28	95	65	M12	4	15	232
ODB025	25	20	16	14	14	34	105	75	M12	4	15	288
ODB032	32	25	16	14	14	42	115	85	M12	4	15	544
ODB040	40	32	16	16	18	51	140	100	M16	4	20	836
ODB050	50	40	16	16	18	62	150	110	M16	4	30	902
ODB063	63	50	16	19	18	78	165	125	M16	4	35	1074
ODB075	75	65	16	19	18	92	185	145	M16	4	40	1368
ODB090	90	80	16	21	18	108	200	160	M16	8	40	1516
ODB110	110	100	16	22	18	128	220	180	M16	8	40	1960
ODB125	125	100	16	22	18	135	220	180	M16	8	40	1938
ODB140	140	125	16	26	18	158	250	210	M16	8	50	2866
ODB160	160	150	16	27	22	178	285	240	M20	8	60	3576
ODB180	180	150	16	27	22	191	285	240	M20	8	60	3298
ODB200	200	200	16	28	22	235	340	295	M20	8	70	5318
ODB225	225	200	16	28	22	238	340	295	M20	8	70	5500
ODB250	250	250	16	31	22	288	406	350	M20	12	80	6962
ODB280	280	250	16	31	22	294	406	350	M20	12	80	7092
ODB315	315	300	16	34	22	338	460	400	M20	12	100	9428
ODB355	*355	350	16	39	23	377	520	460	M20	16	120	19285
ODB400	*400	400	16	43	27	430	580	515	M24	16	140	21370



ODB - Flange ISO-DIN series

Reference	d	DN	*PMA (bar)	b	d ₂	d ₆	D	K	M	n	**Nm	g
ODB450	*450	450	10	44	26	516	670	620	M24	20	150	30000
ODB500	*500	500	10	45	26	533	678	620	M24	20	150	34000
ODB560	*560	600	10	50	30	618	790	725	M27	20	170	49000
ODB630	*630	600	10	50	30	645	790	725	M27	20	170	40000

