

Floor trap with Multi-inlets

- EN 1329 Solvent Welded PVC-U Fittings
- B s2 d0 Fire Reaction Euroclass
- Color: RAL 7037 Grey

Water seal 50 mm in compliance with UNI EN1253

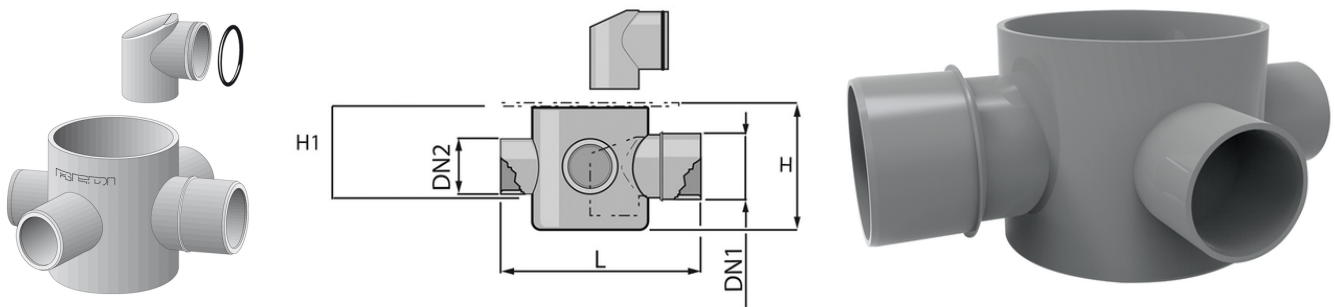

Reference	H (mm)	H1 (mm)	DN1 (mm)	DN2 (mm)	Ø (mm)	L (mm)	H2 (mm)	Version
1961202	137,5	92	75	50	150	237,5	50	HIGH (reinforced share)
19613B2	107,5	82	75	50	150	237,5	35	LOW