

OKDB – Profile backing ring PP

Profile backing ring PP with cast iron core according to DIN standard. Drilled: PN 10/16 up to d180, PN10 from d200 to d630.

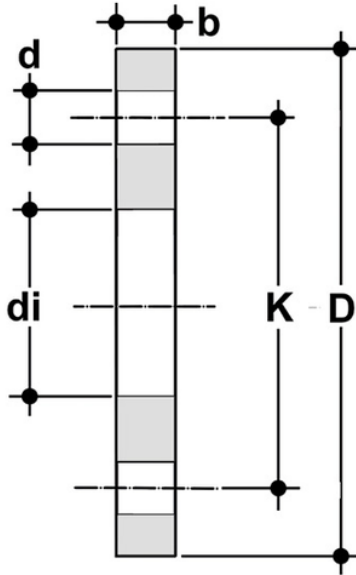

Reference	d	DN	**PMA (bar)	b	D	d	K	M	***n	Nm	g
OKDB032	*32	25	16	18	122	14,5	85	M12	4	15	40
OKDB040	*40	32	16	18	142	18	100	M16	4	15	50
OKDB050	*50	40	16	19	155	18	110	M16	4	20	70
OKDB063	*63	50	16	20	170	18	125	M16	4	30	90
OKDB075	*75	65	16	21	191	18	145	M16	4	40	125
OKDB090	*90	80	16	21	206	18	160	M16	8	40	130
OKDB110	*110	100	16	22	226	18	180	M16	8	40	155
OKDB125	*125	100	16	23	226	18	180	M16	8	40	140
OKDB140	*140	125	16	25	256	18	210	M16	8	50	170
OKDB160	*160	150	16	28	291	22	240	M20	8	60	250
OKDB180	*180	150	16	27	291	22	240	M20	8	60	240
OKDB200	*200	200	16	29	346	22	295	M20	8	80	350
OKDB225	*225	200	16	29	346	22	295	M20	8	80	350
OKDB250	*250	250	16	31	404	22	350	M20	12	80	435
OKDB280	*280	250	16	31	404	22	350	M20	12	80	425
OKDB315	*315	300	16	40	456	22	400	M20	12	90	750
OKDB355	*355	350	16	55	521	22	460	M20	16	110	1135
OKDB400	*400	400	16	57,5	584	26	515	M24	16	120	1490
OKDB450	*450	400	10	56	690	26	620	M24	20	130	2070
OKDB500	*500	500	10	56	690	26	620	M24	20	140	1962



OKDB – Profile backing ring PP

Reference	d	DN	**PMA (bar)	b	D	d	K	M	***n	Nm	g
OKDB560	*560	600	10	64	804	30	725	M27	20	150	3210
OKDB630	*630	600	10	64	804	30	725	M27	20	160	2755