

BBE-L SDR 11 - Complete union

Complete union, longspigot, for butt welding with EPDM or FKM O-ring SDR 11 - S5.

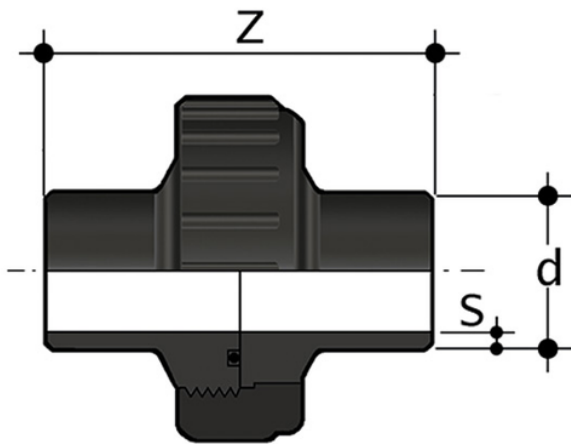

EPDM

Reference	d	Z	S	g
BBEL11020E	20	190	1,9	68
BBEL11025E	25	190	2,3	107
BBEL11032E	32	190	2,9	140
BBEL11040E	40	190	3,7	214
BBEL11050E	50	190	4,6	299
BBEL11063E	63	190	5,8	491

FKM

Reference	d	Z	S	g
BBEL11020F	20	190	1,9	68
BBEL11025F	25	190	2,3	107
BBEL11032F	32	190	2,9	140
BBEL11040F	40	190	3,7	214
BBEL11050F	50	190	4,6	299
BBEL11063F	63	190	5,8	491

BBE-L SDR 11 – Complete union

- Size range: d 12 ÷ d 800 (mm)
- Nominal pressure: SDR 11 (PN16) with water at 20 °C
- Temperature range: -40 °C ÷ 60 °C
- Coupling standards – Reference standards:
 - Welding: EN ISO 15494. Can be coupled to pipes according to EN ISO 15494
 - Flanging system: ISO 7005-1, EN 1092-1, EN ISO 15494, ANSI B16.5 cl.150
 - Construction criteria: UNI EN ISO 15494
 - Test methods and requirements: UNI EN ISO 15494
 - Installation criteria: DVS 2202-1, DVS 2207-1, UNI EN 12201- 3, UNI 10520, ISO 21307, UNI 10521, UNI EN 1555-3, ISO 4427- 3, ISO 4437-3
- Fitting material: PE-HD
- Seal material: EPDM, FKM