

# QBE SDR 33 - Stub flange

Stub flange, short spigot, for butt welding for ISO/DIN backing rings SDR 33 - S 16.

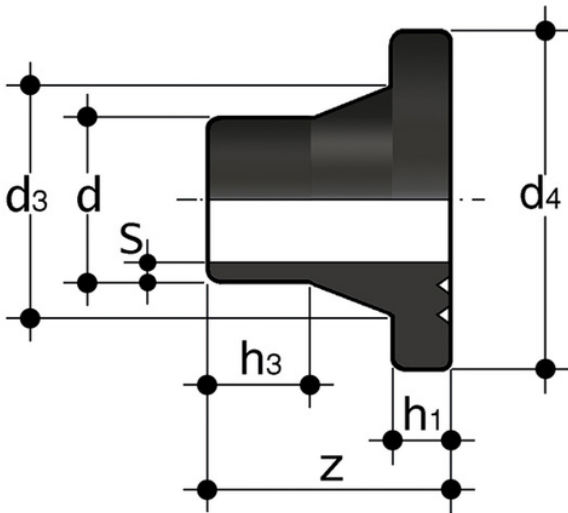

Reference	d	h <sub>1</sub>	h <sub>3</sub>	d <sub>3</sub>	d <sub>4</sub>	Z	S	g
QBE33110	*110	18	37	125	158	83	3,4	310
QBE33125	*125	18	44	132	158	87	3,9	308
QBE33140	*140	18	35	155	188	83	4,3	420
QBE33160	*160	18	43	175	212	95	4,9	555
QBE33180	*180	18	62	186	212	84	5,5	535
QBE33200	*200	18	60	232	268	121	6,2	1195
QBE33225	*225	18	65	235	268	121	6,9	960
QBE33250	*250	20	60	285	320	119	7,7	1765
QBE33280	*280	20	71	291	320	118	8,6	1375
QBE33315	*315	20	86	335	370	165	9,7	2490
QBE33355	*355	23	100	373	430	180	10,9	3590
QBE33400	*400	26	100	427	482	195	12,3	5440
QBE33450	*450	33	60	514	585	139	13,8	7470
QBE33500	*500	38	60	530	585	138	15,3	6560
QBE33560	*560	40	60	615	685	139	17,2	9840
QBE33630	*630	40	80	642	685	142	19,3	7520
QBE33710	*710	35	50	737	800	135	21,8	13060
QBE33800	*800	36	60	840	905	150	24,5	15000

## QBE SDR 33 – Stub flange

- Size range:  $d 12 \div d 800$  (mm)
- Nominal pressure: SDR 17 (PN10) with water at 20 °C, SDR 11 (PN16) with water at 20 °C
- Temperature range:  $-40 \text{ °C} \div 60 \text{ °C}$
- Coupling standards – Reference standards:
  - Welding: EN ISO 15494. Can be coupled to pipes according to EN ISO 15494
  - Flanging system: ISO 7005-1, EN 1092-1, EN ISO 15494, ANSI B16.5 cl.150
  - Construction criteria: UNI EN ISO 15494
  - Test methods and requirements: UNI EN ISO 15494
  - Installation criteria: DVS 2202-1, DVS 2207-1, UNI EN 12201- 3, UNI 10520, ISO 21307, UNI 10521, UNI EN 1555-3, ISO 4427- 3, ISO 4437-3
- Fitting material: PE-HD
- Seal material: EPDM, FKM